

Malleable Iron Pipe Fittings

CRANE

Reducing Socket (Fig 179)

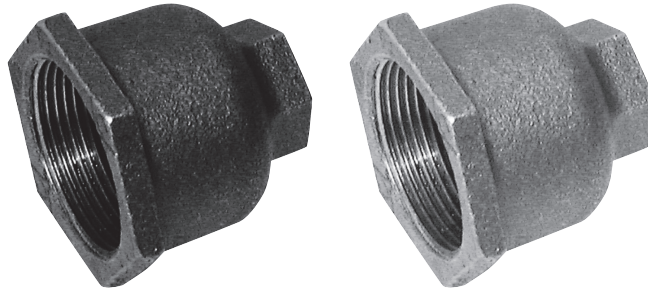
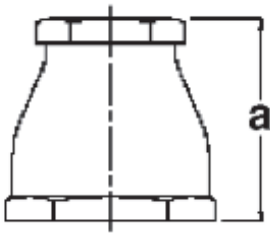

| FITTING SIZE (inch) | DIMENSIONS (mm) a | WEIGHT (kg) per 100 pieces |
|------------------------|----------------------|-------------------------------|
| *3/8 x 1/4 | 29 | 4.71 |
| 1/2 x 1/4 | 32 | 7.60 |
| 1/2 x 3/8 | 32 | 8.40 |
| 3/4 x 1/4 | 37 | 12.70 |
| 3/4 x 3/8 | 37 | 7.62 |
| 3/4 x 1/2 | 37 | 14.35 |
| 1 x 1/4 | 43 | 11.14 |
| 1 x 3/8 | 43 | 18.23 |
| 1 x 1/2 | 45 | 14.75 |
| 1 x 3/4 | 43 | 19.80 |
| 1 1/4 x 1/2 | 52 | 24.91 |
| 1 1/4 x 3/4 | 52 | 26.97 |
| 1 1/4 x 1 | 50 | 20.60 |
| 1 1/2 x 1/2 | 59 | 33.85 |
| 1 1/2 x 3/4 | 59 | 33.60 |
| 1 1/2 x 1 | 59 | 37.76 |
| 1 1/2 x 1 1/4 | 55 | 27.30 |
| 2 x 1/2 | 71 | 48.40 |
| 2 x 3/4 | 71 | 48.90 |
| 2 x 1 | 71 | 54.10 |
| 2 x 1 1/4 | 65 | 43.10 |
| 2 x 1 1/2 | 71 | 57.81 |
| 2 1/2 x 1/2 | 83 | 62.58 |
| 2 1/2 x 1 | 83 | 77.50 |
| 2 1/2 x 1 1/4 | 83 | 78.60 |
| 2 1/2 x 1 1/2 | 83 | 83.58 |
| 2 1/2 x 2 | 83 | 88.68 |
| 3 x 1 | 94 | 97.80 |
| 3 x 2 | 94 | 110.10 |
| 3 x 2 1/2 | 94 | 108.60 |
| 4 x 2 | 111 | 194.40 |
| 4 x 2 1/2 | 111 | 196.30 |
| 4 x 3 | 111 | 202.70 |
| 6 x 4 | 149 | 443.93 |